



Configure Screen Backlight

On a Geo 7x with Windows Mobile





Configure Screen Backlight

Summary

This document aims to provide a quick understanding of how to configure the screen backlight on an Windows Mobile Device.





Configure Screen Backlight

Navigating Menu's

1. Select "Windows" icon to get into the Windows 'Home' screen.
2. Scroll down and select 'Settings' icon.
3. Scroll down and select 'System' icon.
4. Select 'Backlight' Icon.

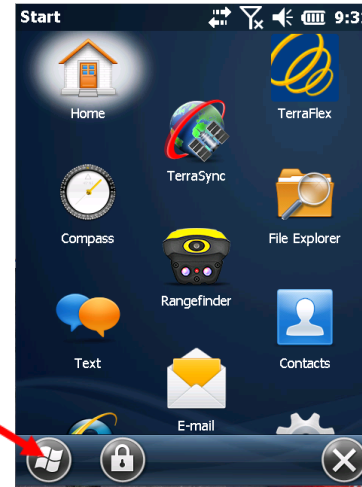

1

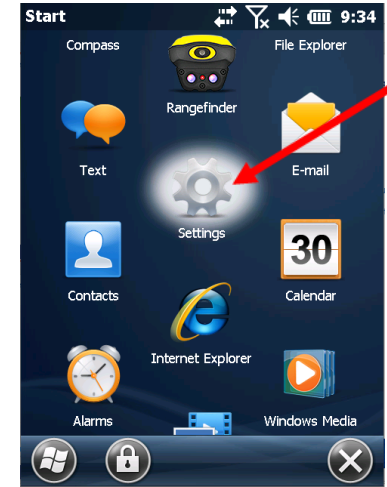

2

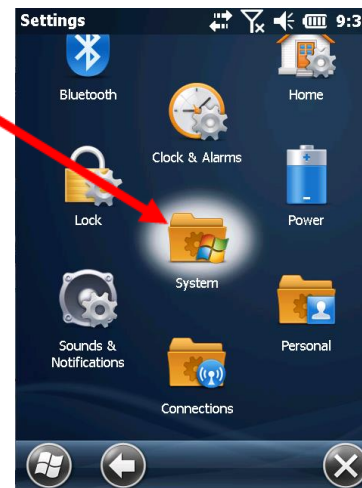

3



4



Configure Backlight Settings

5. Navigate Backlight Settings menu by clicking the 'Arrows' at the top of the screen.
6. Once you have configure settings as desired, click the 'OK' button icon to 'save' the new settings.

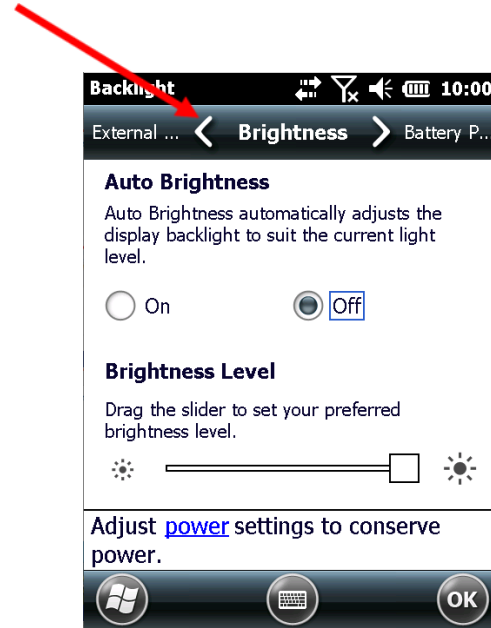

5

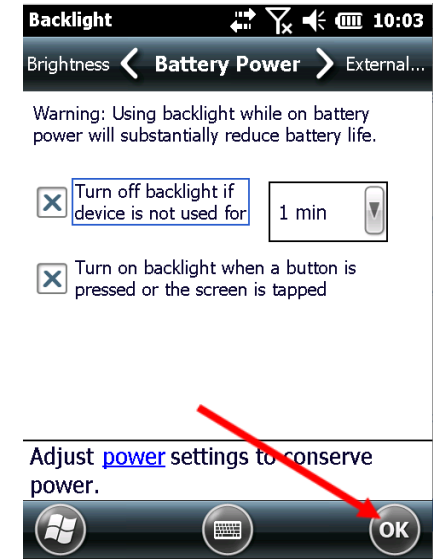

6



e-Learning

E-Learning@Cansel.ca

Support: 1.800.357.0561
cansel.support@cansel.ca

